

ATX200 (FSR)
2002-2008 Discontinued

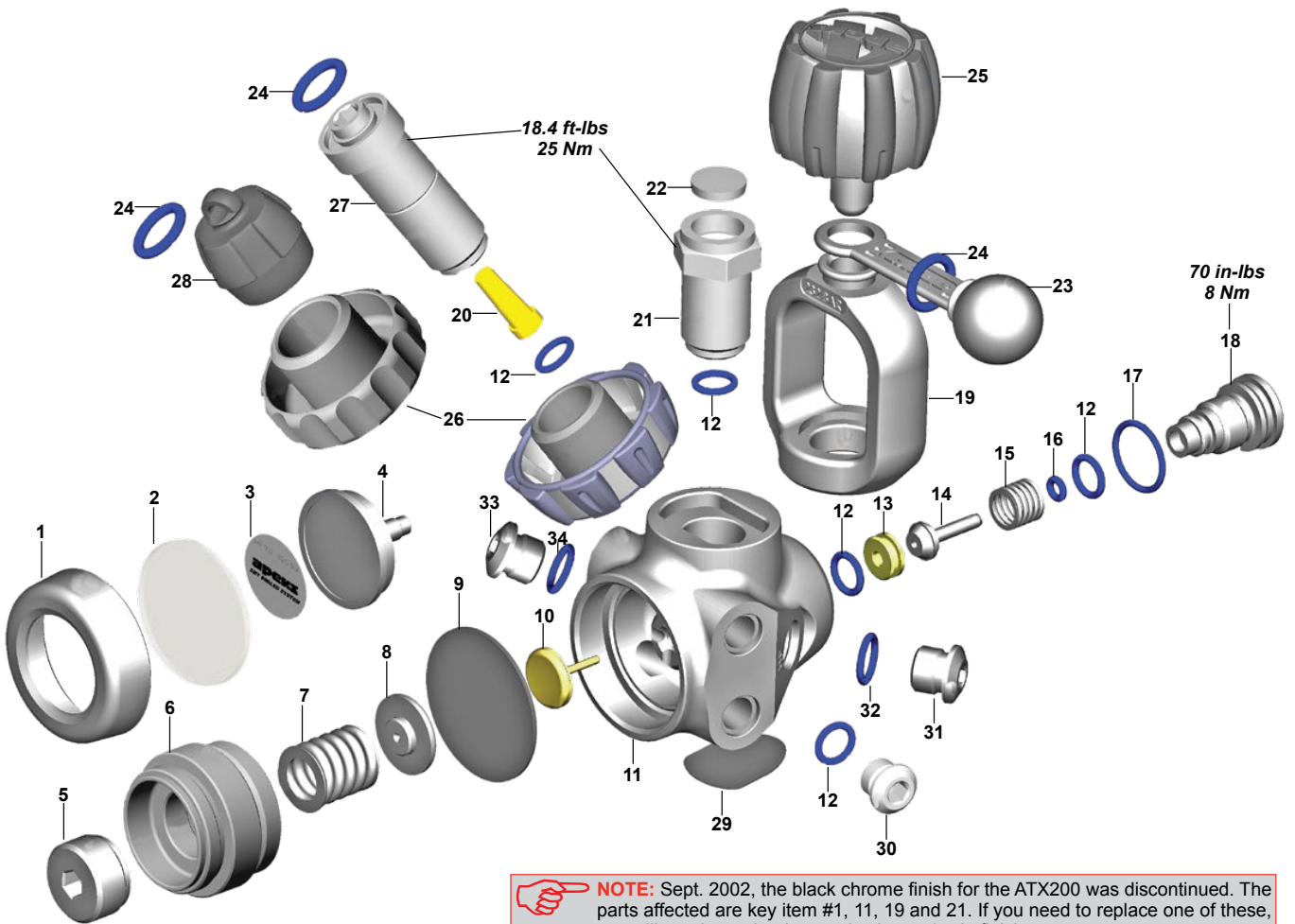

NOTE: Sept. 2002, the black chrome finish for the ATX200 was discontinued. The parts affected are key item #1, 11, 19 and 21. If you need to replace one of these, you will need to order the part in chrome/satin finish.

KEY#	PART#	DESCRIPTION
-----	RT141114	Service Kit, Diaphragm First Stage
-----	RA112115	DIN Conversion Kit, Satin, ATX
-----	RA112118	DIN Conversion Kit, Comolded, Tungsten
1	RG912070	Environmental End Cap, Satin
-----	RG912069	Environmental End Cap, PVD, Tungsten
2	RG912065	Hydrostatic Diaphragm, ATX
-----	RG912066	Hydrostatic Diaphragm, Tungsten
3	RG912347	Decal
4	RG912067	Hydrostatic Transmitter
5	RG912061	Spring Adjuster
6	RG912060	Diaphragm Clamp, Satin
7	RG912271	Spring
8	RG912362	Spring Carrier
9	RG912062	Diaphragm
10	RG912115	Valve Lifter
11	RG912320	Body, Chrome, XTX (2013>)
-----	RG912321	Body, XTX Tungsten (2013>)
12	RG912229	O-ring (10 pk)
13	RG912114	Removable HP Valve Seat (Crown)
14	RG912048	HP Valve
15	RG912047	Spring
16	RG912227	O-ring (10 pk)
17	RG912228	O-ring (10 pk)

KEY#	PART#	DESCRIPTION
18	RG912108	HP Balance Plug, Satin
-----	RG911117	HP Balance Plug, Chrome, Tungsten
19	RG912037	Yoke Clamp, Satin
-----	RG912298	Yoke Clamp, PVD, Tungsten
20	RG912059	Conical Filter (DIN)
21	RG912299	Yoke Clamp Connector, Satin
-----	RG912041	Yoke Clamp Connector, Chrome, Tungsten
22	RG912040	Filter, Porvair (Yoke)
-----	RA121117	Filter, Porvair (20pk)
23	RG912038	Protective Cap
24	RG912224	O-ring (10 pk)
25	RG912417	Yoke Clamp Screw, Comolded
26	RG912056	Handwheel, 300 Bar, Satin
-----	RG912217	Handwheel, 300 Bar, Tungsten
27	RG912058	Handwheel Connector, Satin
-----	RG912057	Handwheel Connector, Chrome, Tungsten
28	RG912127	Protective Cap, DIN
29	RG912464	Decal, Body, XTX200 (2013>)
30	RG912042	3/8" MP Blanking Plug
31	RG912045	7/16" HP Blanking Plug
32	RG912453	O-ring (10 pk)
33	RG912072	1/2" MP Blanking Plug
34	RG912230	O-ring, ATX (10 pk)

Part numbers in **BOLD ITALICS** indicate standard overhaul replacement part.